

Land off Cherry Tree Hill, Coalbrookdale TF8 7EQ



£ 15,000 region

Interesting piece of ground, measuring approx 136 m², within the heart of the Gorge and suitable for a number of purposes. With scope for development (subject to necessary planning consents).



Block Plan 1:500

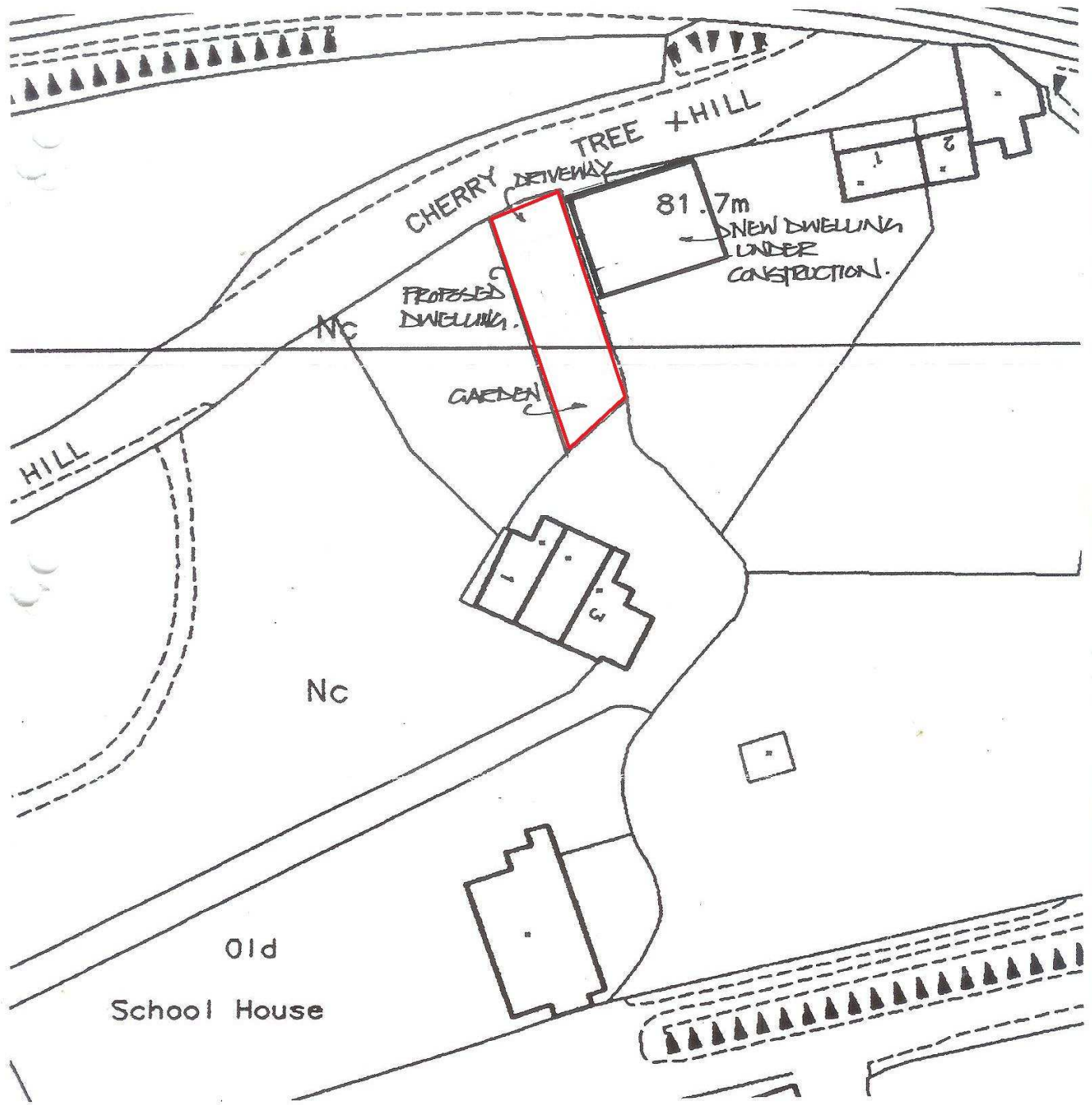

Details prepared : 15th December 2011

Ref: 1689